



Reverse Osmosis Desalinators



Marine *Whisper* Series

Marine Whisper™ Series

Aqua Whisper™ and Ultra Whisper™

Providing fresh water—and peace of mind—to boat owners worldwide



For over 20 years, Sea Recovery Reverse Osmosis (R.O.) Desalinators have been providing fresh, pure water to sail and power boats worldwide. Our products feature intelligent design, marine-grade materials, and a craftsman's attention to detail. The result is a reliable, long-lasting watermaker trusted by boat owners everywhere.

The best fit for your boat

Whether you own a small craft or a mega-yacht, we've got a watermaker with the right capacity and configuration to suit you. Our Ultra Whisper and Aqua Whisper models provide a range of watermaking capacities, from 170 U.S. gallons (644 litres) to 1,500 U.S. gallons (5,678 litres) per day. And because each model is configured a little differently, you have optimal flexibility in selecting the system that best fits into your boat's available space.

Full testing and worldwide service

Each and every system is fully tested and ready to produce water upon installation, with design and construction that enables easy maintenance. And if you ever need assistance, our worldwide service network is there to help, regardless of your location.

ABS certificate of approval

In 1985, Sea Recovery set the standard by becoming the only R.O. Desalination manufacturer to gain Full Product Line Acceptance by the ABS (American Bureau of Shipping). And today we're still the only manufacturer to achieve that certification.

CE approval

All Sea Recovery systems are CE Approved and meet stringent safety requirements.

NMMA membership

For over 20 years, Sea Recovery has been an active member in good standing with the National Marine Manufacturers Association (NMMA).

Certifications and standards

In a continuous effort to achieve the highest possible quality, Sea Recovery manufactures all equipment to industry standards set forth by marine and industrial institutions, including the ASME, ASTM, API, AWWA, NEC, and NEMA. Our equipment also meets certain military specifications and several other rigorous standards and requirements.



AquaWhisper™

The Aqua Whisper™ Advantage

Sea Recovery's Aqua Whisper R.O. desalinators are designed and constructed for years of high performance. Here are a few of the reasons these watermakers stand apart from the competition:



The Touch Pad Control Panel allows simple touch operations and provides illuminated status indication.



Microprocessor-controlled electronics offer boat owners state-of-the-art technology and reliability.



Vibration Isolator Mounts dampen vibration and noise.*



Touch Pad Remote Control conveniently gives your system status and allows operation from a second location on the boat.



Commercial Pre-Filter and Oil/Water Separators provide unparalleled particulate and oil removal at no extra charge.*

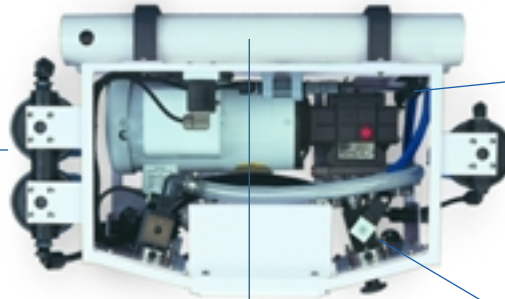

A marine-grade High Pressure Pump, specifically designed for reverse osmosis, offers durability, corrosion resistance, and longevity. It's also 10dB quieter—that's 10 times quieter—than other pumps.



Fiberglass Pressure Vessels eliminate corrosion and offer a stronger and more durable housing for the R.O. membranes.*



High-Pressure Fittings are stainless steel and offer a double O-Ring Seal to prevent the leakage and stress cracking that can occur with lower-quality pipe threads.



The Fresh Water Flush feature automatically flushes your system with fresh water after each use. And when the system is not in use, a unique timing feature allows it to automatically flush itself once every seven days.*

*Commercial Pre-Filter and Oil/Water Separator housing and elements are offered FREE OF CHARGE, if requested at time of initial order.
 **Also applies to the Ultra Whisper models.

Aqua Whisper™ Frame

17, 25, 33, 50, 63 Gallons Per Hour | 63, 95, 126, 189, 237 Litres Per Hour



Model No:

SRC AWF 400-1
 SRC AWF 600-1
 SRC AWF 800-1
 SRC AWF 800-2
 SRC AWF 1200-2
 SRC AWF 1500-2

The workhorse Aqua Whisper Frame (AWF) has proven itself time and again under difficult sea conditions, making it a favorite of boat owners and outfitters worldwide. This system produces from 400 to 1,500 U.S. gallons (1,514 to 5,678 litres) per day of safe,

clean, potable water, so it's perfect for large and mega-sized yachts. It draws its power from the vessel's onboard generator, and can be installed in various locations such as engine room compartments.

The AWF features a stainless steel triplex plunger pump that's specifically designed for seawater, and a unique drive assembly composed entirely of marine-grade materials. The result? A reliable, powerful, smooth-running watermaker.

Aqua Whisper™ Compact

17, 25, 33, 50, 63 Gallons Per Hour | 63, 95, 126, 189, 237 Litres Per Hour



Model No:

SRC AWC 400-1
 SRC AWC 600-1
 SRC AWC 800-1
 SRC AWC 800-2
 SRC AWC 1200-2
 SRC AWC 1500-2

The Aqua Whisper Compact (AWC) Desalinator combines small size, efficiency, and quiet operation due to its stainless steel triplex plunger pump. The AWC is 30% smaller than the Aqua Whisper Frame, yet it still delivers the identical watermaking

capabilities. The high-efficiency booster pump can be mounted remotely at a location closer to the seacock. With a height of only 14 inches (356mm), the AWC can be installed in a wide range of locations onboard, from spaces under berths and

settees to closets and engine room compartments. Recommended for small to midsize power and sail boats, the AWC's daily watermaking capacity ranges between 400 to 1,500 U.S. gallons (1,514 to 5,678 litres), depending upon the model selected.

Aqua Whisper™ Modular

17, 25, 33, 50, 63 Gallons Per Hour | 63, 95, 126, 189, 237 Litres Per Hour



Model No:

SRC AWM 400-1
 SRC AWM 600-1
 SRC AWM 800-1
 SRC AWM 800-2
 SRC AWM 1200-2
 SRC AWM 1500-2

The Aqua Whisper Module (AWM) brings quiet watermaking and tremendous installation flexibility to boats that are tight on space. All of the components needed for R.O. desalination can be custom installed by

placing them in any available space onboard to best fit the specific layout of the boat. The AWM's components can be tucked away under berths and settees, and in closets and engine rooms. The system

comes with the Touch Pad Control Panel for easy operation. Daily watermaking capacity ranges between 400 to 1,500 U.S. gallons (1,514 to 5,678 litres), depending upon the model.

Aqua Whisper™ I70

7 Gallons Per Hour | 27 Litres Per Hour



Model No:

SRC AWI70 12VDC
 SRC AWI70 24VDC
 SRC AWI70 110AC
 SRC AWI70 220AC

Owners of small sail and power boats can enjoy fresh water at an affordable price, thanks to the unique Aqua Whisper I70. It is designed and engineered to provide low-volume watermaking in a compact, easily maintained package. The AW I70 can fit into

tight spaces that previously couldn't accommodate a watermaker, and its low-amperage power requirements (12 or 24 VDC, and 110 or 220 VAC) make it an efficient, convenient choice for small-boat owners.



Installation Kits, included with every system, contain all necessary items needed to install your SRC Watermaker.

Ultra Whisper™

with EfficientSea™ Technology

Valve Chamber...controls pressure cycles

Ultra quiet...virtually no noise

Optional polishing for a sleek look

Cross-over Manifold...directs fluid flow

Automatic Pressure Regulation

Pressure Booster Chamber...exchanges brine energy to feed water

Simplistic design with minimal parts...eases repair, troubleshooting, and maintenance

Elegant yet rugged... investment casting, light-weight, high-performance design

The ultimate in automated, quiet and efficient watermakers

Sea Recovery's new Ultra Whisper™ Desalinator—with its unique EfficientSea™ Energy Transfer technology—brings efficient, compact, extraordinarily quiet watermaking to small and midsize power or sail boats.

The unit's Energy Transfer Device eliminates the need for a high-pressure pump, reducing the electricity consumption of the R.O. system by as much as 75%. The R.O. process is achieved by recovering energy from the pressurized brine discharge and transferring that energy to relatively low-pressurized

feed water. An ingeniously designed manifold and a two-valve flow control system deliver smooth, constant, fault-free automatic operation with no valves to adjust.

The Ultra Whisper's high-performance design is created from Super Austenitic Stainless Steel, a very high-alloy stainless steel with elevated Molybdenum content and strengthened with Nitrogen, which increases resistance to pitting and crevice corrosion. This added strength makes it truly superior to competitors' models.

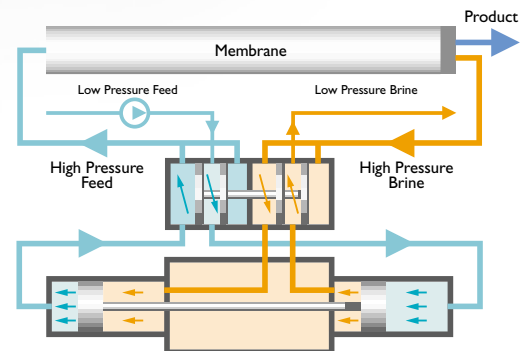

Ultra Whisper™ Modular

8, 17, 25 Gallons Per Hour | 32, 63, 95 Litres Per Hour

Model No:

SRC UWM 200-I
SRC UWM 400-I
SRC UWM 600-I



The new Ultra Whisper Modular (UWM) Desalinator is ideal for sail and power boats with limited onboard power—and even less onboard space. It easily adapts to virtually any boat design and installation location. The com-

ponents needed for R.O. desalination are custom installed by placing them in any available space onboard, such as under berths and settees, and in closets and engine rooms. Everything that's needed to install the UWM

system is included in one complete package. The flexibility of this modular system provides a quiet, efficient watermaking system that can fit any boat perfectly.

Ultra Whisper™ Compact

8, 17, 25 Gallons Per Hour | 32, 63, 95 Litres Per Hour

Model No:

SRC UWC 200-I
SRC UWC 400-I
SRC UWC 600-I



The new Ultra Whisper Compact (UWC) Desalinator allows for easy installation in boats that previously didn't have room for a conventional R.O. system. Now, installation sites can include spaces under berths and settees, and in closets and engine room

compartments. And, an open designed frame allows easy access to the system's internal components during regularly scheduled maintenance. Now, small and midsize power or sail boats have a new option for providing fresh, clean water onboard.

Sea Recovery Options and Accessories

Genuine Sea Recovery quality

To keep your Sea Recovery R.O. desalinator in top running condition for many years, we recommend using only genuine Sea Recovery options and accessories. These high-quality products will enable you to safely operate and monitor your system as they protect the quality of your drinking water. All of the products below are options/accessories for the Aqua Whisper models; the Fresh Water Flush and the Ultraviolet Sterilizer are enhancements for the Ultra Whisper models as well.

Touch Pad Remote Control



The convenient Touch Pad Remote Control gives system status and allows operation

from other locations on the boat. This system gives you wired remote control of three basic operations—Start, Stop, and Fresh Water Flush activation—plus four illuminated status indications: Power On, System On, Pure Water, and Fresh Water Flush. The remote system includes a neutral gray flush-mountable remote panel and 75 feet of installation cable.

SRC R/AW, 4.75" L x 2.75" H
120.65mm x 69.85mm

Commercial Pre-Filter

The Commercial Pre-Filter replaces the Standard Dual Pre-Filter, providing longer intervals between necessary filter cleaning and replacement. This extra-long-life filter guards the R.O. membranes by filtering the feed water to a 5 micron rating. A pressure gauge and a bleed valve are included.



SRC CPF/AW, 13" L x 10.75" W x 16.75" H
330.20mm x 273.05mm x 425.45mm



Multi Media Filter Assembly

Using a graduated media filter bed consisting of gravel and sand, the Multi Media Filter traps suspended solids larger than 30 microns, extending cartridge filter life. It's recommended for boats in areas where the feed water has a high concentration of suspended particles and biological growth such as plankton. Inlet and outlet pressure gauges are included.

SRC MMF/AW, 15" L x 10.5" W x 21.5" H
381mm x 266.70mm x 546.10mm



Fresh Water Flush

The Fresh Water Flush greatly extends the life of the R.O. membranes by rinsing them with fresh water after each use. It will remove saltwater from the system's internal parts and flush the membrane with clean, fresh water. This prevents saltwater corrosion of the internal parts and reduces biological fouling of the R.O. membrane. And when the system is not being used, a unique timing feature allows it to automatically flush itself once every seven days.

SRC FWF/AW, 18.5" H x 12.625" L x 8" D
469.90mm x 320.68mm x 203.20mm



Ultraviolet Sterilizer

The Ultraviolet Sterilizer is the final filtration process where 99.8% of all microorganisms, including reproducing bacteria and viruses, are sterilized. Replacement U.V. lamps are also available.

SRC UV/AW, 14" L x 3.25" W x 3.25" H
355.60mm x 82.55mm x 82.55mm

Oil/Water Separator

The Oil/Water Separator protects the R.O. membranes from oily or polluted water sources. Through a coalescing process, any oil present in the feed water is separated out, extending the life and

efficiency of the system's membranes and increasing water purity.

SRC OWS/AW, 13" L x 10.75" W x 16.75" H
330.20mm x 273.05mm x 425.45mm

Clean Rinse Valve Panel

The Clean Rinse Valve allows for easy R.O. membrane maintenance and system rinsing.



SRC CRV, 14" L x 3.25" W x 3.75" H
355.60mm x 82.55mm x 95.25mm

Soft Motor Starter

The Soft Motor Starter (SMS) reduces amps needed for start-up by more than 50%, allowing operation with smaller generators.

SRC SMS, 5.875" W x 5" H x 4.5" D
149.23mm x 127mm x 114.30mm



Commercial High Seas™ Series

Sea Recovery's Coral Sea™, Tasman Sea™ and North Sea™



Fresh water in high volume

From the Bahamas to the Bering Sea, when there's a need for fresh water in high volume, our High Seas Series™ of commercial-grade R.O. Desalinators are the ideal choice. They are delivered as complete systems with all plumbing included, so they're ready to produce water immediately after installation.

All High Seas systems are constructed with a lightweight, epoxy-coated frame and utilize only the highest quality marine-grade materials and components. And, they're backed by Sea Recovery's technical support group, worldwide.

Coral Sea™ Re-designed!

1,800 to 6,300 U.S. gallons per day
6,822 to 23,877 litres per day

The new Coral Sea models have been re-designed to offer higher watermaking capacities and even quieter, more efficient operation compared to previous models. Their more powerful production capabilities make them ideal for mega-yachts, commercial fishing vessels, work boats, oil rigs, and charter boats, and for onshore facilities as villas, small hotels, and private residences.

The new models feature a state-of-the-art controller with a user-friendly LCD touch-screen interface and a Programmable Logic Controller (PLC) for easier operation. We've incorporated all stainless steel piping, hard plumbing, and Chemical Duty motors into these units, and we've built in redundant safety systems as well.

The new Coral Sea Systems are available in a vertical, horizontal, or modular configuration. Our Fresh Water Flush system is available as an option.

Tasman Sea™

4,700 to 17,500 U.S. gallons per day
17,791 to 66,245 litres per day

Our Tasman Sea models are the next step up in watermaking capacity, with the power to supply pure, fresh water to small hotels, large villas, oil platforms, and small cruise ships.

North Sea™

10,000 to 44,000 U.S. gallons per day
37,854 to 166,558 litres per day

When a huge volume of fresh water is needed—regardless of location or conditions—it's our North Sea models that get the call. These systems have the power to supply fresh water to large hotels, cruise ships, villages, and other large facilities.

Features and benefits

- Exclusive high-efficiency Booster Pump for extended pre-filter life.
- Unique low-voltage control circuitry, shielded terminals, and covered high voltage components for end-user safety.
- Exclusive solid state Salinity Meter shows actual product water quality, an essential tool for product water monitoring.
- A fail-safe Product Water Diversion Valve allows only safe drinking water to enter storage tanks.
- Dedicated heavy-duty Magnetic Latching Relays for each motor integrated in the system allows for the booster pump to operate independently for system priming, flushing, and cleaning.
- Corrosion-proof Hour Meter for keeping accurate ship's logs and schedule preventative maintenance.
- Clear viewable Sea Strainer with a cleanable Monel Mesh Screen Filter for ultimate corrosion resistance and large particulate removal.
- Marine-grade crankcase oil extends the life of the high pressure pump.
- Stainless steel, liquid-filled pressure gauges for accurate measurement and corrosion resistance as well as vibration damping.
- New Dual Flow Meter for visual monitoring of the brine and product flow.
- Commercial grade, chemically resistant R.O. Membranes, backed by a one-year warranty.
- All fiberglass Membrane Pressure Vessel for corrosion-proof performance.
- All high-pressure connections and manifolds are 316L stainless steel for maximum corrosion resistance.
- A comprehensive manual with exploded part views and connection drawings for installation, operation, and maintenance.
- Worldwide service and sales network for immediate attention regardless of location.
- One-year warranty on the system and membranes.
- Technical service and repair department dedicated to system performance excellence.

Specifications

Sea Water Conditions for System Specification:

(+/-15% at 820 psi / 56.5 bar, 77°F / 25°C & 35,000 ppm TDS Feed Water Salinity)

Product Water Produced:

Model Number	Per 24 Hrs	Per Hr
AW 170	170 Gallons / 644 Liters	7 Gallons / 27 Liters
AW 400	400 Gallons / 1,514 Liters	17 Gallons / 63 Liters
AW 600	600 Gallons / 2,271 Liters	25 Gallons / 95 Liters
AW 800	800 Gallons / 3,028 Liters	33 Gallons / 126 Liters
AW1200	1200 Gallons / 4,542 Liters	50 Gallons / 189 Liters
AW1500	1500 Gallons / 5,678 Liters	63 Gallons / 237 Liters
UW 200	200 Gallons / 758 Liters	8 Gallons / 32 Liters
UW 400	400 Gallons / 1,514 Liters	17 Gallons / 63 Liters
UW 600	600 Gallons / 2,271 Liters	25 Gallons / 95 Liters

Salt Rejection (Chloride Ion): Minimum 99.2%, Average 99.4%

Product Water Temp: Ambient to feed water temperature

Salinity Monitoring: Fail safe automatic computer controlled electronic monitoring.

System Feed Water:

Model Number	Cycles	Feed Water Flow Per Minute
AW 170 AC	50 Hz	0.4 Gallons / 1.6 Liters
AW 400-1500	50 Hz	3.5 Gallons / 13.2 Liters
AW 170 DC & AC	60 Hz	0.5 Gallons / 1.9 Liters
AW 400-1 & 800-2	60 Hz	3.0 Gallons / 11.4 Liters
AW 600-1, 800-1, 1200-2 & 1500-2	60 Hz	4.2 Gallons / 15.9 Liters
UW 200	60 Hz	1.5 Gallons / 5.7 Liters
UW 400		2.5 Gallons / 9.4 Liters
UW 600		3.5 Gallons / 13.2 Liters

Salinity Range of Feed Water: Sea Water up to 50,000 ppm TDS (NaCl) (typical 35,000 ppm)

Temperature Range: Maximum - 122°F/50°C, Minimum - 33°F/5°C

Reverse Osmosis Membrane Type: High Rejection / High Flow aromatic tri-polyamid, thin film composite, spiral wound, reverse osmosis membrane element.

Chlorine Tolerance: 0.1 PPM pH Range: 3-11 (typical seawater pH is 8)

System Pressure:

Feed Water: Min: 2-6 psi/.41 bar/42 Kg/cm2
Max: 30-35 psi/2.41 bar/2.46 Kg/cm2
Operation: Seawater nominal: 850 psi/56.5 bar/57.66 Kg/cm2 (Brackish varies w/ppm)

Weight:

Model Number	Weight	Model Number	Weight
SRC AW 170	55 Lbs / 25 Kg	SRC AWM 400-1	113 Lbs / 51 Kg
SRC AWF & C 400-1	147 Lbs / 67 Kg	SRC AWM 600-1	116 Lbs / 53 Kg
SRC AWF & C 600-1	150 Lbs / 68 Kg	SRC AWM 800-2	125 Lbs / 57 Kg
SRC AWF & C 800-2	159 Lbs / 72 Kg	SRC AWM 1200-2	131 Lbs / 59 Kg
SRC AWF & C 1200-2	165 Lbs / 75 Kg	SRC AWM 1500-2	136 Lbs / 62 Kg
SRC AWF & C 1500-2	170 Lbs / 77 Kg	SRC UW 200	125 Lbs / 57 Kg
		SRC UW 400	140 Lbs / 64 Kg
		SRC UW 600	150 Lbs / 68 Kg

External Installation Water Connections: Pipe sizes to be supplied by the installer for connection of the Sea Recovery supplied components.

	AW 170	All Other AW Systems	UW Systems
Feed Inlet:	1/2" FNPT	3/4" FNPT	1/2" FNPT
Brine Discharge:	1/2" FNPT	1/2" FNPT	1/2" FNPT
Product:	1/4" MNPT	3/8" MNPT	1/4" MNPT

Electrical Power Requirements

(HP = Horse Power; FLA = Full Load Amperes; LRA = Locked Rotor Amperes Start Up)

High Pressure Pump Motor:

AW 170 Systems

VDC	VAC	HP	FLA
12V/24V DC		0.33	27/13.4
	115/230	0.33	7.2/2.8

AW 400-1 & 800-2 Systems

Phase	Hz	VAC	HP 50Hz	HP 60Hz	FLA	LRA
Single	*50/60	115	2.2	2.2	*21/18	*121/94
Single	*50/60	230	2.2	2.2	*10.5/9	*60/47
Three	50/60	208/280	2.5	3.0	9/4.6	77/39
Three	50/60	230/460	2.5	3.0	8.2/4.1	70/35

AW 600-1 & 1200-2, and 800-1 & 1500-2 Systems

Phase	Hz	VAC	HP 50Hz	HP 60Hz	FLA	LRA
Single	50/60	115	2.2	2.6	21.2	109
Single	50/60	115/230	2.2	2.6	10.6	54.5
Three	50/60	208/280	2.5	3.0	9/4.6	77/39
Three	50/60	230/460	2.5	3.0	8.2/4.1	70/35

UW 200C/200M Systems

VDC	Hz	Phase	HP	FLA
12V DC			.10	9.0
24V DC			.10	4.5
VAC	Hz	Phase	HP	FLA
115	50/60	Single	.10	5.1/4.4
230	50/60	Single	.10	2.5/2.2
230	50/60	Three	.10	0.4/0.4

UW 400C/400M Systems

VDC	Hz	Phase	HP	FLA
12V DC			.25	22.0
24V DC			.25	11.0
VAC	Hz	Phase	HP	FLA
115	50/60	Single	.25	6.7/5.8
230	50/60	Single	.25	3.3/2.9
230	50/60	Three	.25	1.2/1.0

UW 600C/600M Systems

VAC Phase	Hz	Phase	HP	FLA
115	50/60	Single	.50	11.3/9.8
230	50/60	Single	.50	5.6/4.9
230	50/60	Three	.50	2.3/2.0

Specifications Subject to Change Without Notice.
* Dependent upon hertz.

Dimensions

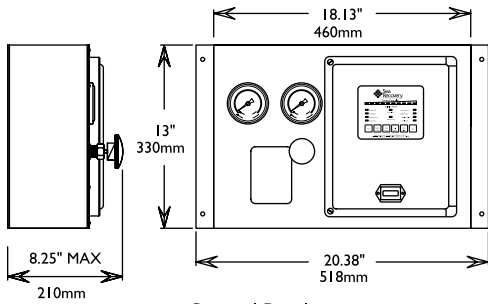
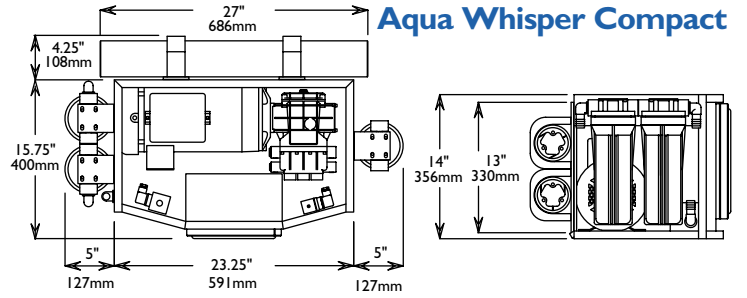
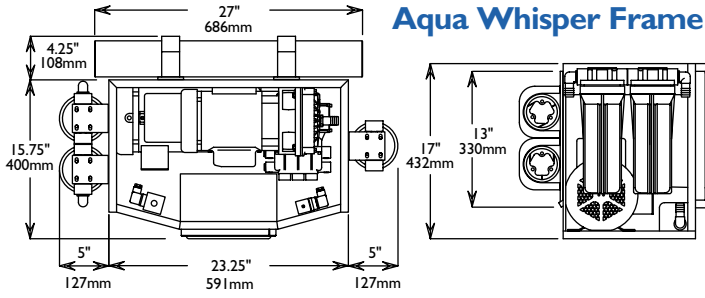

Aqua Whisper Modular

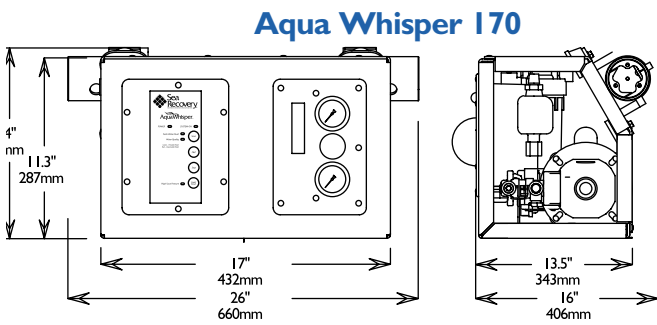
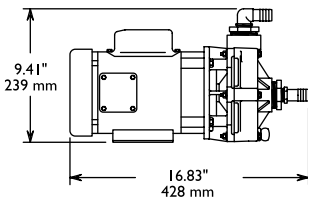
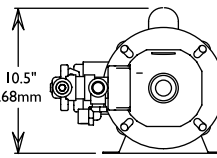
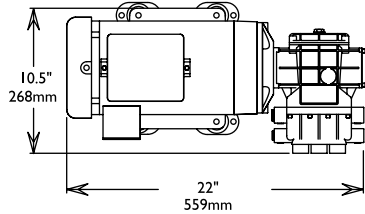

Ultra Whisper Compact

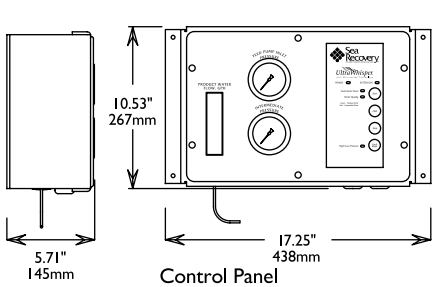
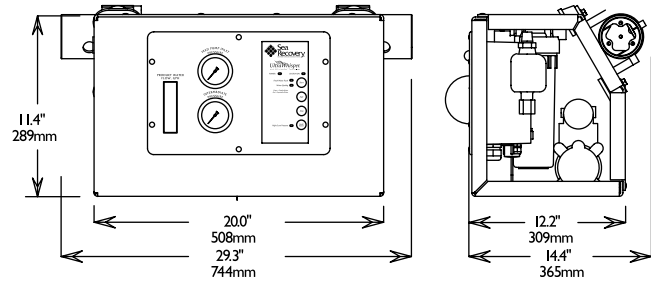

Ultra Whisper Modular

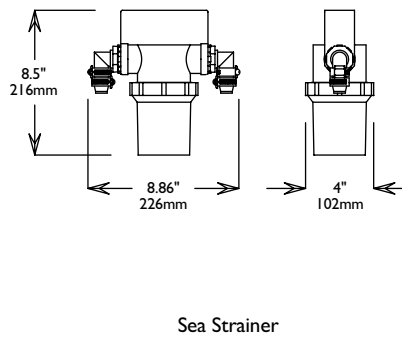
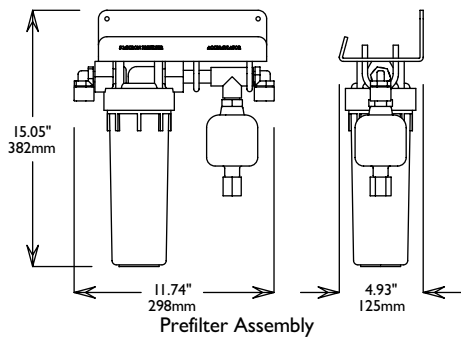
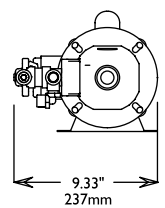
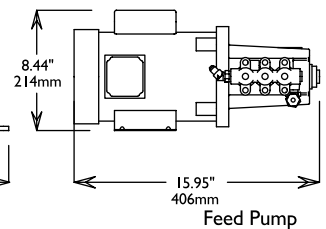
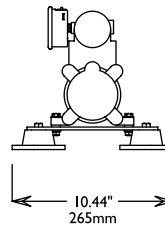
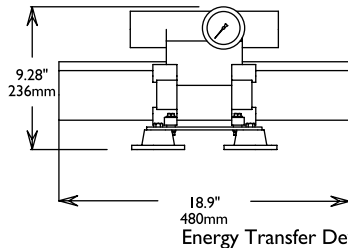

Membranes for All Models

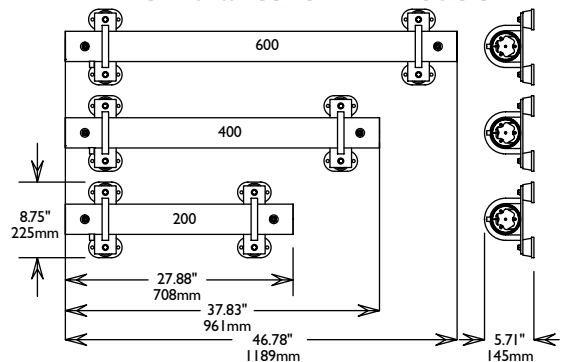

Authorized Dealer:



P.O. Box 2560, Gardena California 90247 U.S.A
Toll Free: 1-800-354-2000 • Tel: 1-310-637-3400 • Fax: 1-310-637-3430
E-Mail: sales@searecovery.com • Web: www.searecovery.com